



PRE-MADE ROOM DESIGN SERVICE

Thank you for choosing our pre-made room design!
The information provided in this document will guide
you through the process.

As always, please ask me any questions you have.

I can't wait to get started on your project!

-Erica

White Hollow
YARD & HOME

www.whitehollowyardandhome.com

Service Details

SIZED FOR YOUR SPACE

Simply provide the layout of your space (see measurements page) and we will make sure everything fits!

If an item doesn't work for your space or is out of stock, we will find a comparable replacement, which you will be able to approve first.

REVISIONS

Don't like the lamps? Prefer blackout curtains? No problem! We allow you to request two product changes to the pre-selected product list.

PAYMENT SCHEDULE

Deposit of \$300 is required to secure services. Once the dimensions of the space are provided, we will work to select the right size products for your space!

An invoice will be provided for the remainder of the package once product pricing is confirmed (product pricing can vary depending on sizing). Payments must be completed before orders are placed.

Measurements



ROOM DIMENSIONS

- Sketch of room with all wall lengths
- Wall heights
- Position and size (height and length) of any obstructions such as radiators



DOORS

- Location of doors in the space
- Width of doorways (including trim)



WINDOWS

- Location of windows in the space
- Width of windows (including trim)
- Height of windows (including trim)
- Distance from floor to bottom of window trim
- Distance from top of window trim to ceiling
- If doing inside mount window shades, we also need:
 - Inside width of windows
 - Inside height of windows
 - Depth of windows (distance from trim to glass)

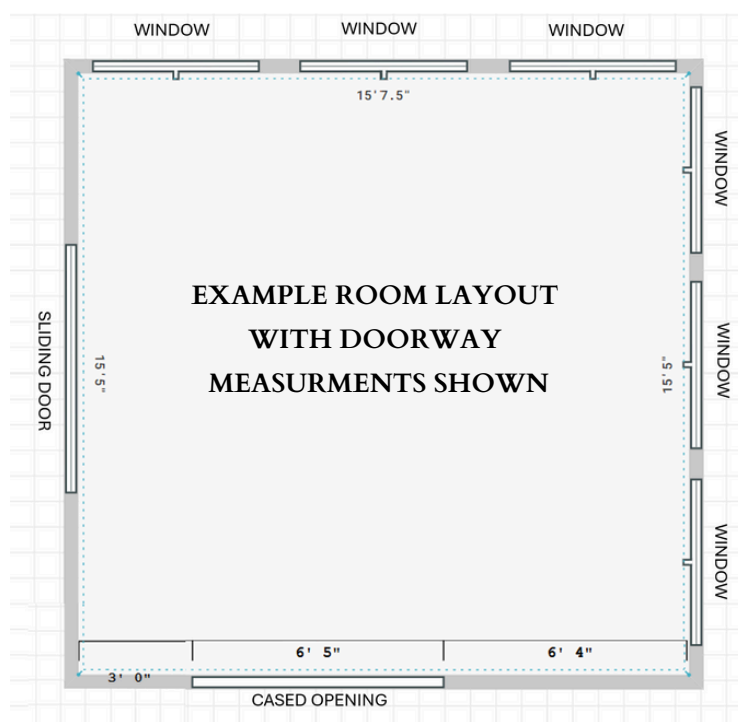

Frequently Asked Questions

Here is some useful information and our most frequently asked questions to help you prepare.

What is the turn around time?

The entire project should take a few weeks. If there are any items on backorder, we will inform you.

Product pricing

We charge the typical retail price for all items (including sales). The price you pay for items will be the same as if you had bought them yourself.

Deliveries

Items will be delivered directly to you from the suppliers (expect A LOT of boxes). We will provide delivery updates as we receive them.

Product Quality

These items are all budget friendly - minor cosmetic defects are common. We will address any noticeable defects with the supplier for you. Please inspect the items for damage or defects within 24 hours of delivery so that exchanges can be made.

What happens if I need to cancel?

Life happens! If you ever need to cancel, please notify us by email. If a payment has already been made, a refund will be given minus any purchases and design fees that have been incurred.

What if I want to return something?

Items with significant defects or damage will be repaired or replaced by the supplier. In the case of buyers remorse, we defer to the supplier's return policy (any labor and shipping expenses will be your responsibility).

Love Your New Space!

After all the hard work is done, we hope that your new space brings you functionality and comfort.